

# RIVER TRENT BURTON STATHER to KEADBY

BI-ANNUAL SURVEY 2024

DEPTHS IN METRES

SCALE 1 : 10000

SURVEYED BY

Harbour Master, Humber

ASSOCIATED BRITISH PORTS

24th October and 7th November 2024

Depths are in metres and decimetres reduced to the chart datum given below  
Underlined figures are drying heights in metres and decimetres above chart datum  
Overhead clearance heights are above Highest Astronomical Tide

PLACE	Heights in metres above Chart Datum				Chart Datum and remarks
	M.H.W.S.	M.H.W.N.	M.L.W.N.	M.L.W.S.	
BURTON STATHER	5.2	3.5	0.3	0.0	1.1m below O.D. Newlyn
FLIXBOROUGH	5.0	3.2	0.0	0.0	0.9m - - - } Being approx. M.L.W.S.
KEADBY	4.8	3.0	0.0	0.0	0.4m - - -

Projection :- Transverse Mercator. National Grid references are given along borders of chart.

Light stars without legends represent two fixed lights displayed vertically and are seen as red to port and green to starboard when proceeding upriver.

Whilst every care was taken in the preparation of this Chart, which is intended to provide Mariners with the data which Associated British Ports possessed at the time of its preparation, ABP gives notice that, therefore, on account of the quickly shifting character of the river bed, no warranty is afforded that such data can be relied upon and, further, no responsibility can be accepted by ABP for any inaccuracies in the Chart or omission therefrom.

Bathymetric soundings shown on this chart are collected to the U.K.I.O. standard: CAT700 C

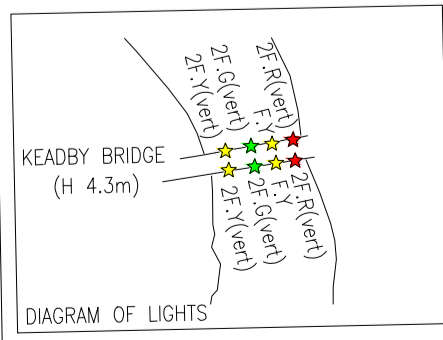
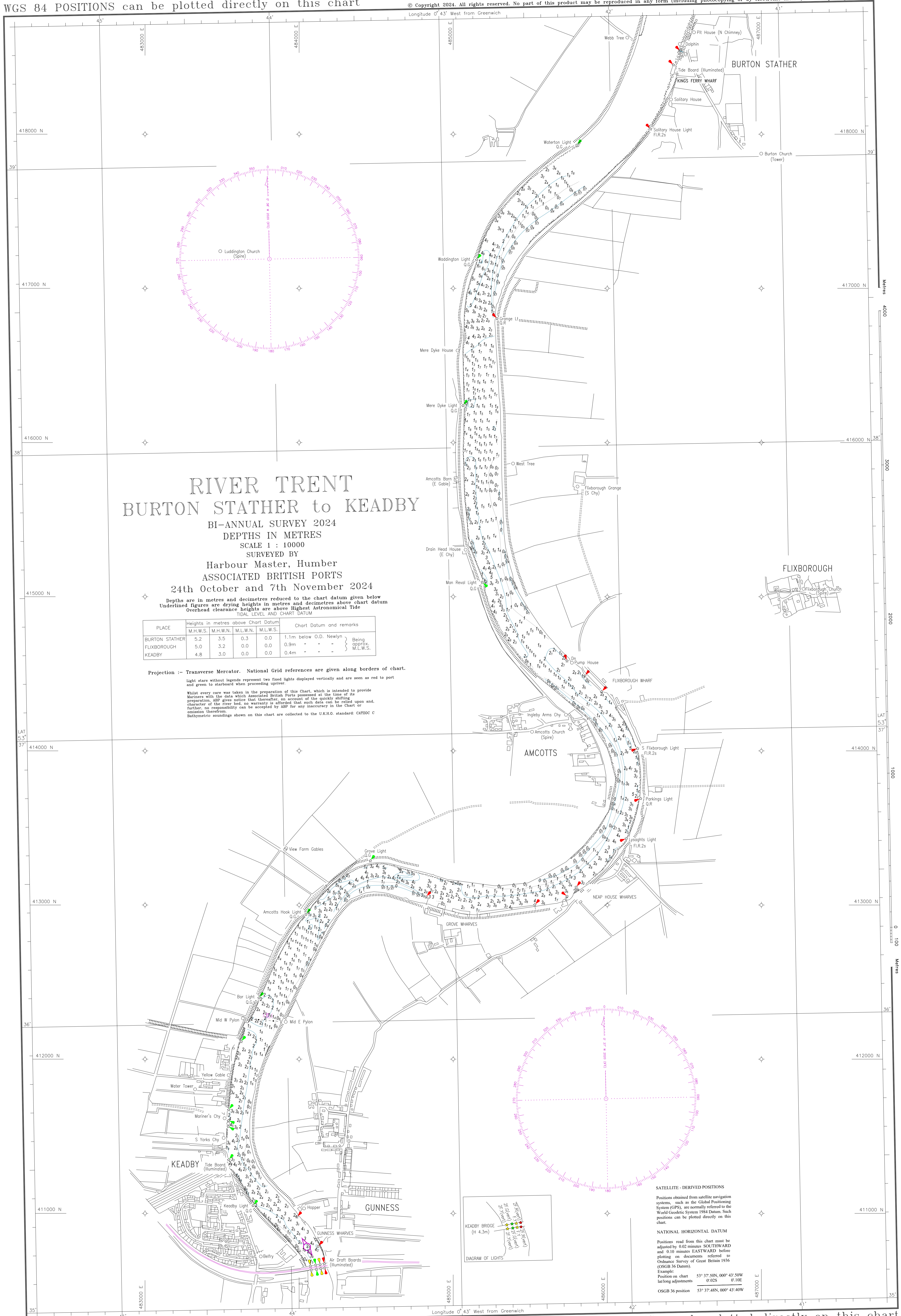

**SATELLITE - DERIVED POSITIONS**  
Positions obtained from satellite navigation systems, such as the Global Positioning System (GPS), are normally referred to as the World Geodetic System 1984 Datum. Such positions can be plotted directly on this chart.

**NATIONAL HORIZONTAL DATUM**  
Positions read from this chart must be adjusted by 0.02 minutes SOUTHWARD and 0.10 minutes EASTWARD before plotting on documents referred to Ordnance Survey of Great Britain 1936 (OSGB 36 Datum).  
Example:  
Position on chart 53° 37' 50N, 000° 43' 50W  
lat/long adjustments 0.02S 07.10E  
OSGB 36 position 53° 37' 48N, 000° 43' 40W